

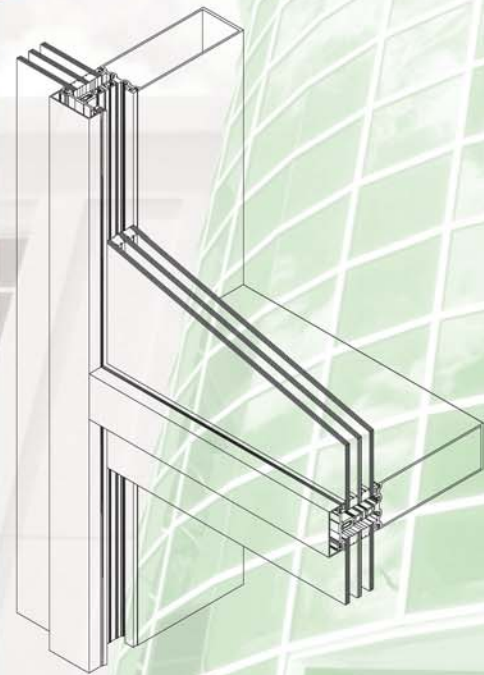

Alumicor



THERMAWALL 2600 Series
High Performance
Curtain Wall

PERFORMANCE BY DESIGN

THERMAWALL

2600 Series
High Performance
Curtain Wall

**features
& benefits**

- Full frame separation means exceptionally high thermal performance
- Select high... or higher levels of thermal performance with double or triple glazed options
- Stick built design makes ThermaWall cost effective and quick to site
- Because ThermaWall's roots are from the VersaWall family, Alumicor's accompanying products such as operable windows, doors and pressure plate caps are easily incorporated
- Integral glass support eliminates the valid concerns surrounding dead loads imposed upon thermal breaks
- Structural Silicone Glazed (SSG) capability offers freedom in design
- Composite action "Bigfoot" thermal break provides increased and cost effective resistance to wind loads
- Owners, Consultants and Authorized Alumicor Dealers can rest assured that ThermaWall has been rigorously tested to all applicable standards of performance with superb results (CSA A440-00; AAMA-501)

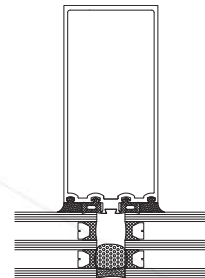
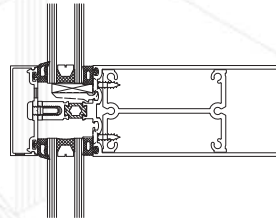
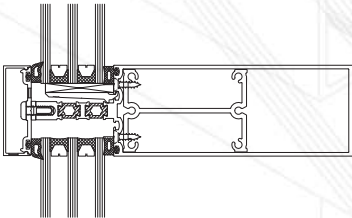

Please contact your authorized Alumicor dealer:

Toronto
1-877-258-6426

Halifax
1-888-346-5151

Winnipeg
1-800-665-3635

Montreal
1-866-586-4267